

SCREENING TESTS SARS-COV-2

INSTRUCTIONS FOR USE

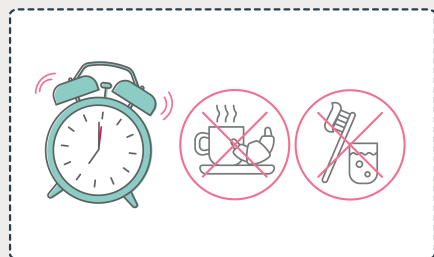

1 Sample must be taken in the morning. Do not eat, do not drink and do not brush teeth before sampling.

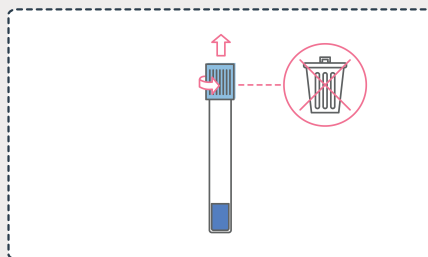

2 Remove the elements from the packaging. Remove the blue cap of the tube, making sure to keep the tube straight.

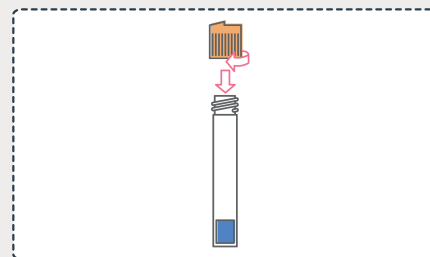

3 Screw the orange adapter onto the sample tube, making sure that the notch on the adapter is pointing up.

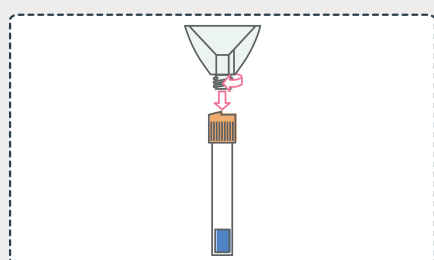

4 Screw completely the funnel onto the adapter.

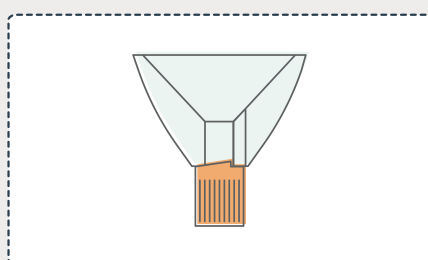

5 Make sure the funnel is in the correct position: the notch on the orange adaptor has to be against the stop notch of the funnel.

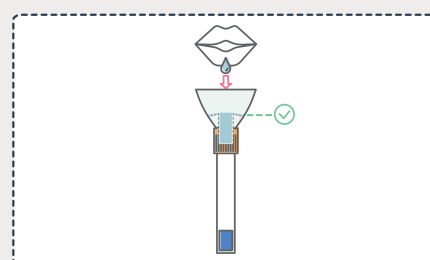

6 Place saliva in the funnel until the central part is completely filled.

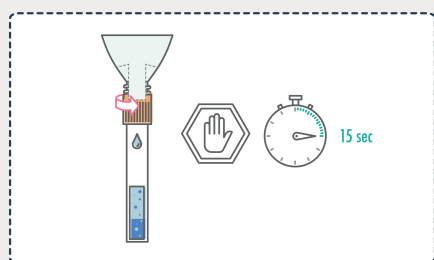

7 Partially unscrew the funnel so that the saliva flows into the sample tube for at least 15 seconds.

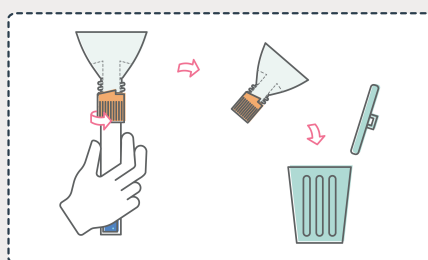

8 Hold the tube straight and unscrew the orange adaptor and funnel and throw them into a closed waste garbage.

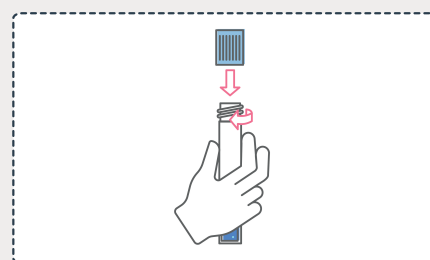

9 Screw completely the blue cap on the tube.

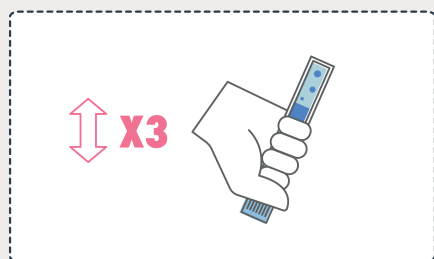

10 Mix saliva and reagent by inverting the tube up and down 3 times.

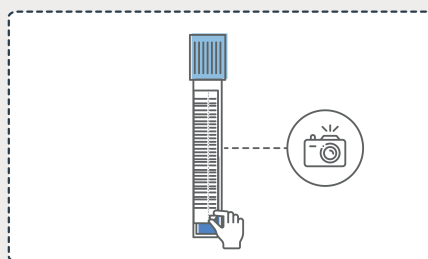

11 Remove the detachable part of the self-adhesive label from the barcode by lifting the blackened corner and keep it* for future reference of the test result. If possible, store the tube in an airtight container or closed pouch. Return the tube to the collection point on the same day.

*Suggestion: Take a picture of the label.